

Mobile Washer Conversion- 4596110 (115V) 4596111 (230V)

Introduction

Your Freestanding glassware washer may be converted to a mobile model using the parts provided. This will replace stationary feet with casters to allow the washer to be easily moved from one location to another. The permanent utility connections for tap water and drain of the Freestanding model will be replaced with a tap water connection system that attaches to a sink faucet and uses the sink drain. The electrical cord will plug into a standard wall outlet.

WARNING: These kits are only intended for the 1.2KW and the 2KW heater models and not the 6KW heater models.

WARNING: This kit does not provide a second hose connection for the pure water supply.

Utility Requirements

Before starting this conversion process, make sure adequate utilities are available in the facility where the glassware washer will be located. The following utilities must be available.

- The water fixture to which the glassware washer will be attached must have a threaded faucet. (See the picture on page 6.)
- The recommended hot water supply temperature should be at least 120°F (49°C).
- The water supply must have a pressure between 20 psi (138 kPa) and 120 psi (827 kPa).
- The water flow must be at least 1.25 gpm (4.7 lpm).
- The sink must be able to drain at least 3 gpm (11 lpm)
- For 115V washers, a receptacle must be available to accept a NEMA 5-20 plug.
- For 230V washers, a receptacle must be available to accept a NEMA 6-20 plug.
- The electrical receptacle for both 115V and 230V washers must be protected by a 20A fuse or circuit breaker.
- The floor where the washer will be located must be level and sound.
- See the User's Manual that came with the Freestanding Glassware Washer for other specifications.

Instructions for Converting a Freestanding to a Mobile Glassware Washer

If the unit has never been installed, proceed to Step 5

1. **WARNING:** Disconnect electrical power to the washer before performing these modifications. Turn off the water supply.
2. Disconnect drain hose connections.
3. Disconnect the hot water and pure water supply plumbing.

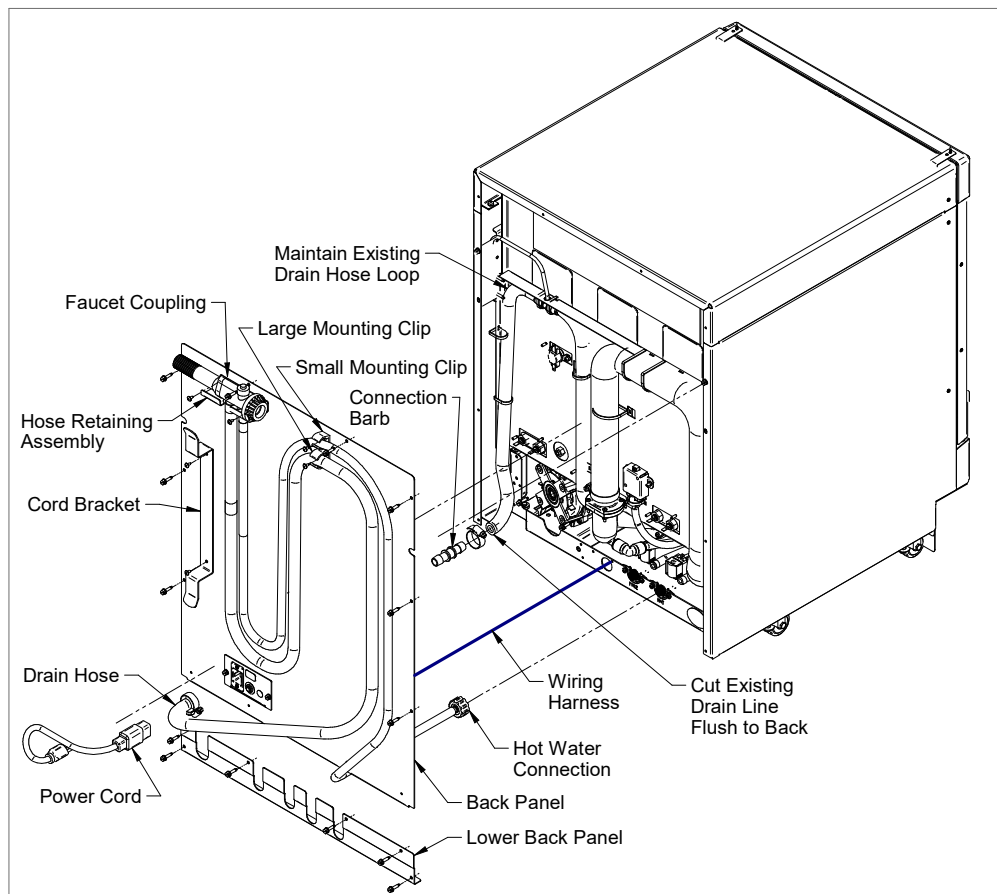

4. Remove the back panels and the lower front toe kick panel.
5. Cut off the excess drain hose even with the back of the base.
6. Disconnect and remove the power wires (if washer had been previously installed) they attach to the washer inside the electrical box, located behind the toe kick panel under the door.
7. Lay the washer on its back and remove the leveling feet. Replace the leveling feet with casters and return the washer to the upright position.

8. Attach the large and small hose mounting clips to the back panel with screws supplied.
9. Attach the cord bracket to the back panel with the screws supplied.
10. Attach the hose retainer assembly to the back panel with the screws supplied. Do not install the back panel to the washer.
11. Route the hot tap water supply hose (smaller hose) that is part of the hose end faucet coupling assembly underneath the back panel and attach it to the hot water connector fitting.
12. If required, route the user supplied pure water supply hose underneath the back panel and attach it to the pure water valve.
13. Route the drain hose (larger hose) that is attached to the hose end faucet coupling underneath the back panel. Push the coupling into the existing drain hose and secure with the two hose clamp supplied.
14. Remove the electrical box by loosening the two screws on each side of the washer base and removing the one screw located at the lower center of the box.

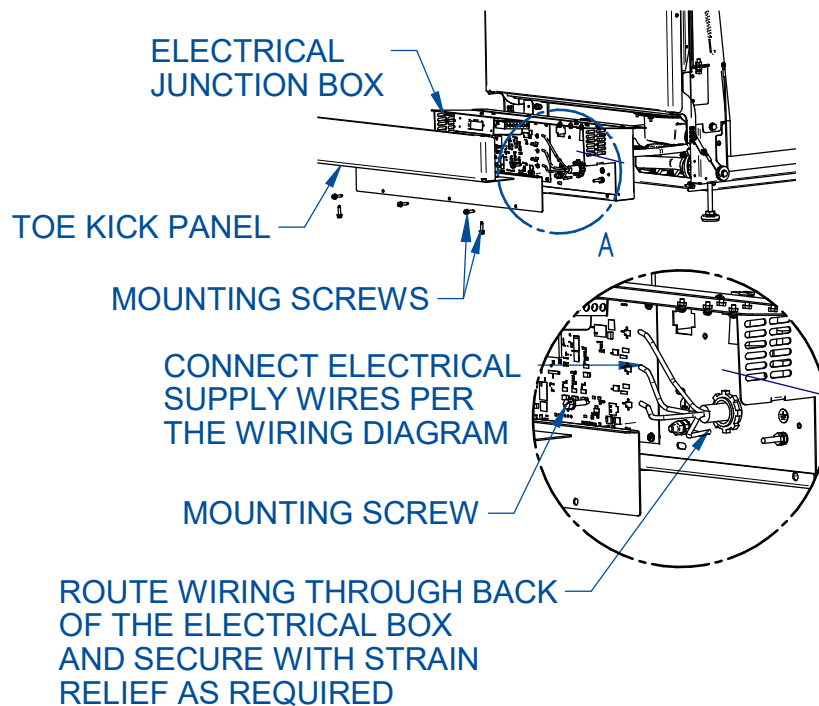

15. Without disconnecting the existing wiring carefully pull the electrical box out enough to gain access to back side.

16. Carefully route the supplied mobile wire harness through the strain relief clamp located in the back center of the base to the strain relief clamp on the back of the electrical box.
17. Connect the supplied wire harness wires to the appropriate lever nuts on the main wiring harness. Refer to the wiring diagram shown below. Make certain the wiring connections match the wiring diagram for the voltage of your unit.

**120/208 V 1 PHASE SERVICE
CONNECT TO LEVER NUT**

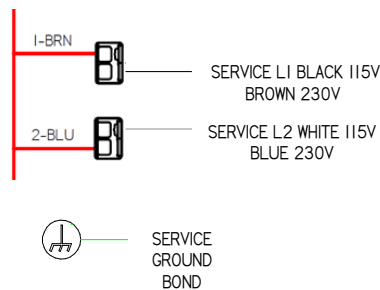

18. Securely connect the ground wire with $\frac{1}{4}$ " ring terminal from the supply cable to the $\frac{1}{4}$ -20 ground stud on the electrical box using the $\frac{1}{4}$ " nut.
19. Secure the cable with the two strain relief clamps at the back of the electrical box and the back of the base.
20. Carefully reinstall the electrical box making sure the slack from the cable does not interfere with the washer's internal wiring, the pump fans or the drain valve linkage.
21. Replace the toe kick panel.
22. Feed the wire harness thru the back panel. Attach the back panel to the washer.
23. Attach the wires in the harness to the terminals in the rear electrical box (See following wiring diagrams).

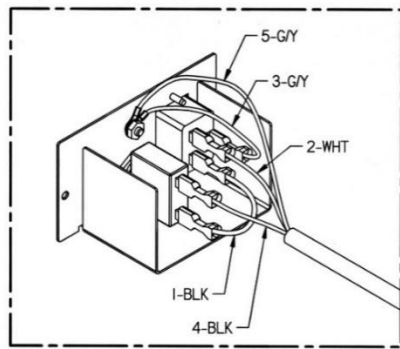

115V

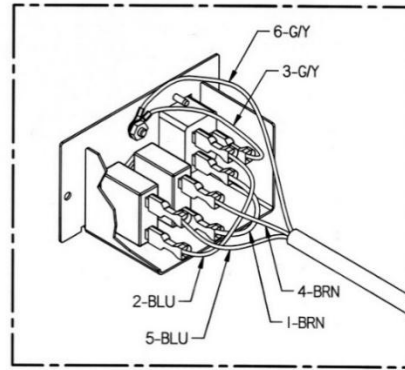

230V

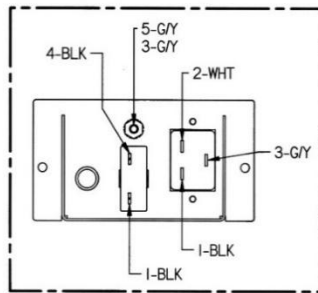

115V

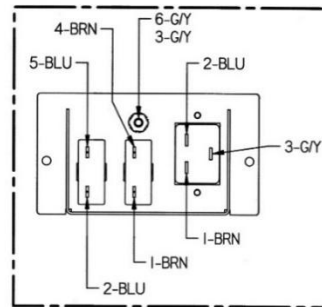

230V

24. Attach the rear electrical junction box to the back panel with the screws removed from the cover plate.
25. Place the hot water supply hose and the drain hose in the clips on the back panel and place the hose end faucet coupling in the hose retainer assembly.
26. Plug the power cord into the receptacle in the rear junction box and wrap the excess around the cord bracket.
27. Replace the lower rear panel.

The modifications for the washer are now complete.

Install Faucet Adapters

An aerator adapter fitting is provided and needs to be installed on the faucet. If the adapter fitting provided does not allow for a tight connection to the faucet, a variety of internally and externally threaded fittings are available at local hardware stores or on line. Use caution when installing the fittings to prevent stripping the threads.

Attach the Hose End Faucet Coupling

The hose end faucet coupling attaches and seals to the aerator adapter by pushing the parts together. The hose end faucet coupling must be snapped into place before turning on the hot water. To install the hose end coupling, pull down

on the plastic release ring and place the coupling over the adapter and release the ring. Turn the water on slowly until the faucet is fully open.

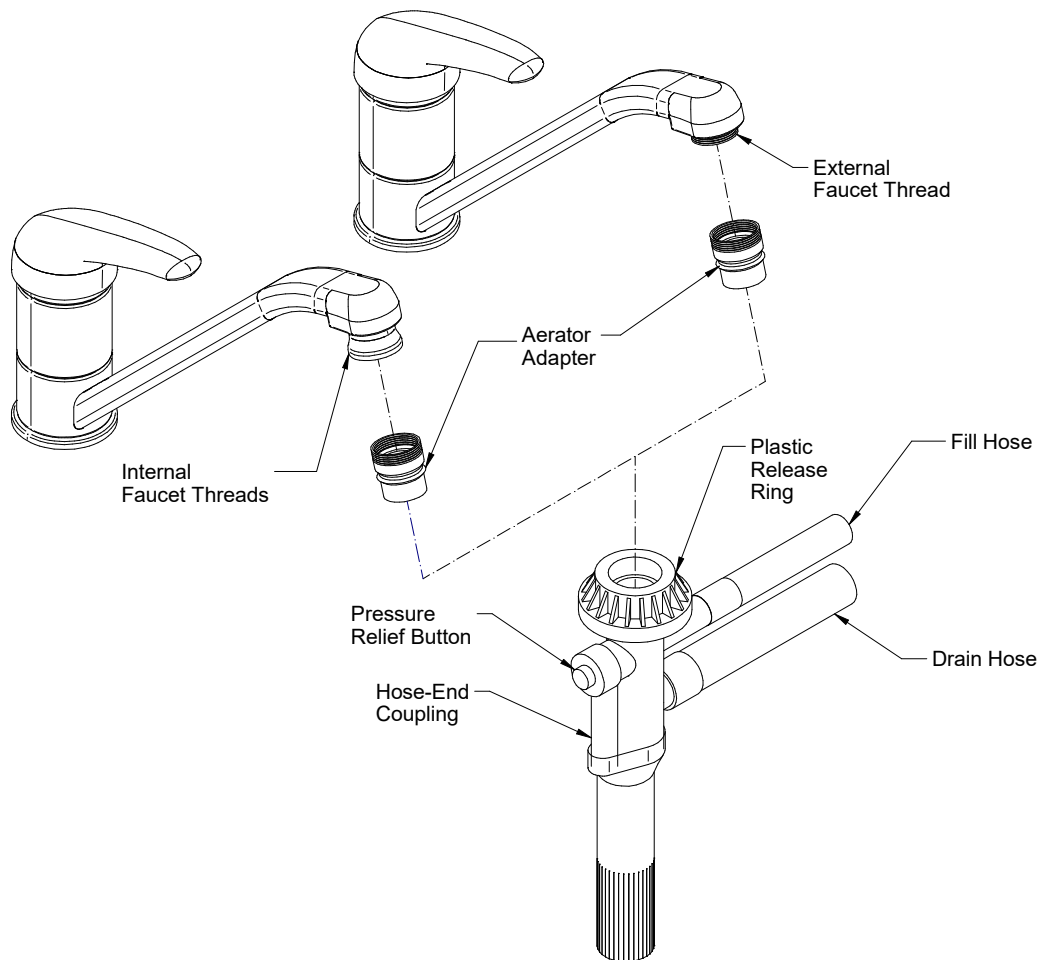

Disconnecting the Hose End Faucet Coupling

The hose end faucet coupling may be removed from the faucet when the glassware washer is not in use.

1. Turn off both the hot and cold water faucets.
2. Push the pressure relief button on the hose end faucet coupling to relieve the water pressure.
3. Pull down on the plastic release ring on the hose end coupling to disconnect it from the faucet.