



**LABCONCO CORPORATION** 8811 Prospect Ave, Kansas City, MO 64132  
(816) 333-8811 or (800) 821-5525 • (816) 363-0130 fax • labconco.com

## Stoppering Tray Dryer Installation Guide

*Note: This Quick Installation Guide may not provide all the information necessary for your particular installation. Refer to the User's Manual for details and precautions.*

### Preparations

#### Proper Electrical Supply

- 115V models
  - 20 Amp dedicated single phase circuit.
  - Properly grounded receptacle for NEMA 5-20P plug.

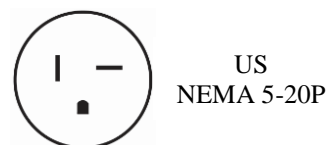

- 230V models
  - 15 Amp dedicated single phase circuit.
  - Properly grounded receptacle that matches the plug supplied with the unit (230V models are supplied with one of the following plugs):



US  
(NEMA 6-15P)

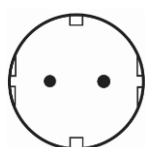

EU



China



UK



India

- If the plug does not match the available receptacle, remove the plug and replace it with an approved plug of the suitable style.
- Note:
  - Additional appliances on the same circuit may cause the current to exceed the rating of the circuit breaker or fuse. Do not connect a Tray Dryer to the same circuit that powers a Freeze Dryer.
  - Frequency must agree with the serial tag rating. Improper frequency will damage the compressor.

# Installation

- Remove the flat gasket if it is in place on the vacuum connection port.
- Remove the 4 plastic plugs from the top of the Freeze Dryer.
- Slide the lower rubber coupling up above the bottom of the stainless steel tube. Snug both clamps on the hose.
- Remove the lower back panel of the Freeze Dryer. DO NOT remove the Freeze Dryer upper panel.
- Place the Tray Dryer on top of the Freeze Dryer aligning the 4 mounting holes and the rubber coupling over the connection port. CAUTION: The Stoppering Tray Dryer weighs over 420 pounds (190Kg), use safe lifting procedures.
- Install four screws, washers and nuts.
- Loosen both clamps on the lower rubber coupling and slide the coupling downward over the 3" connection port until it contacts the plate of the connection port. Align the bottom edge of the lower clamp with the bottom edge of the rubber coupling, then tighten clamp. Align the top edge of the upper clamp with the top edge of the rubber coupling, then tighten clamp.

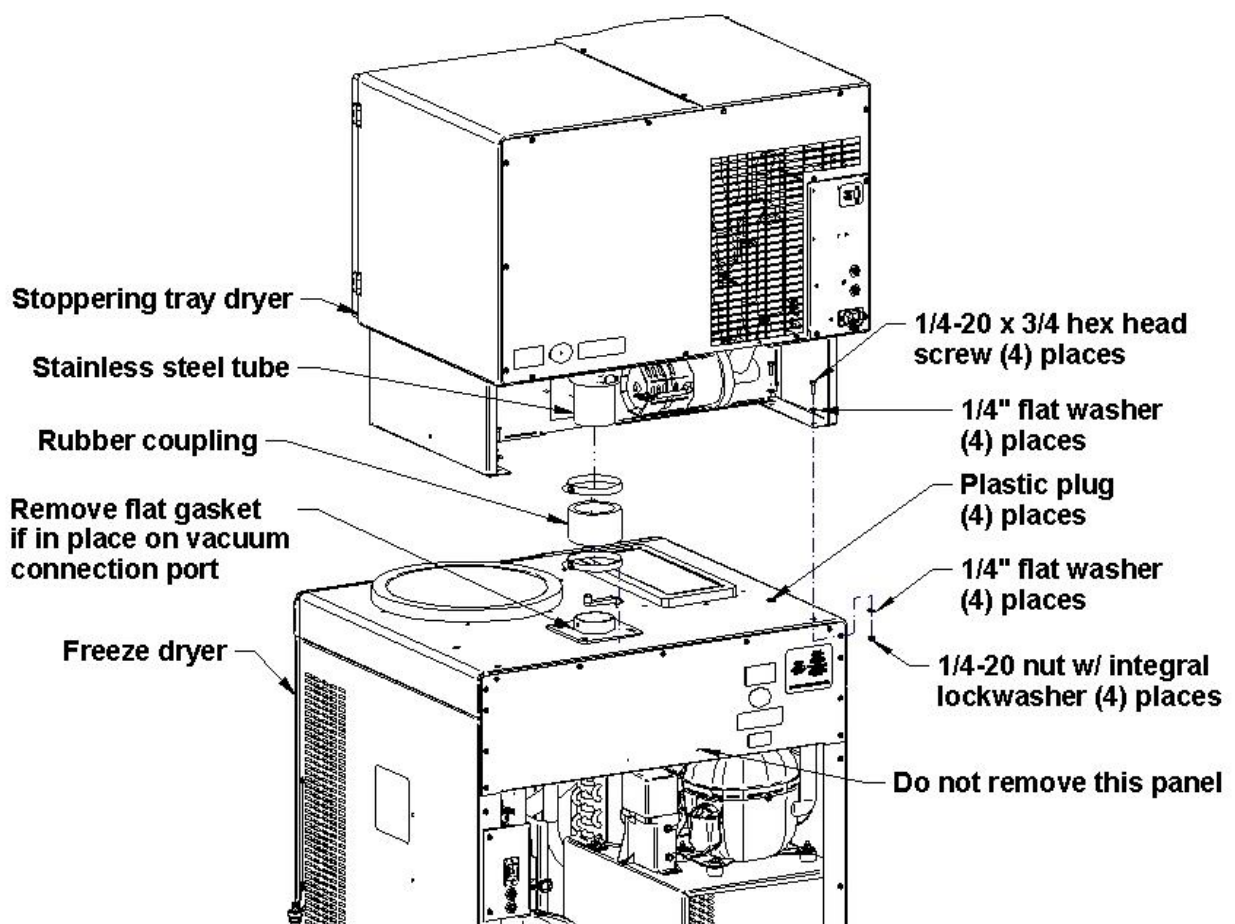

## Electrical Connections

- Connect the power cord into the back of the Tray Dryer and tighten the screw in the connector clamp. Connect the other end into a suitable receptacle.
- Connect the communication cable to the receptacle marked Output to Freeze Dryer and connect the other end into the Freeze Dryer.
- Connect the Ground Strap by removing one of the screws from the Freeze Dryer back panel and attaching the free end of the Ground Strap.
- Connect the sample probes into the receptacles inside chamber.

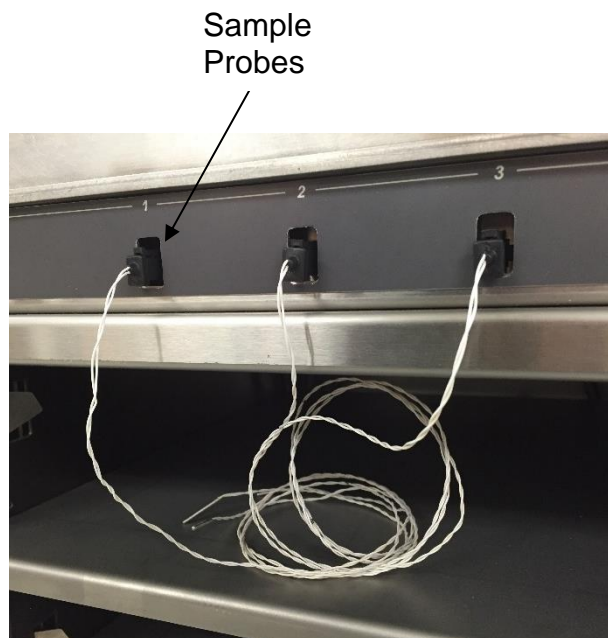
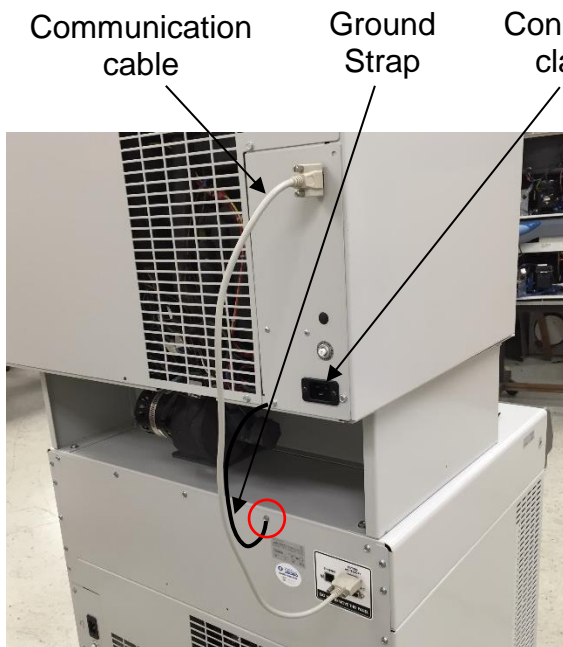

## Vacuum Integrity Test

- Go to the Freeze Dryer Home screen and turn on the Freeze Dryer collector and allow the collector to reach -40°C or colder.
- Close the Tray Dryer door. Make sure the VAC RELEASE valve is set to CLOSE and the STOPPERING valve is set to LOWER.
- Start the vacuum pump (from the Freeze Dryer Home screen).
- Vacuum in the system should reach at least 0.133 mbar within 30 minutes and 0.040 mbar within 18 hours (for clean & dry system).

## Stoppering Tray Dryer Refrigeration Test

- For this test the vacuum pump should be running and the vacuum level in the system should be 0.133 or lower.
- Go to the Drying Accessory screen (on the Freeze Dryer touch screen).
- Press the MANUAL button
- Enter a Shelf Temp Set Point value of -40°C and press the Start button.
- Tray Dryer "System" Temperature should reach -40°C (+/- 1°C) within 2 hours at ambient room temperature of 70°F (21°C).

## Sample Placement on Shelves

**Note:** It is very important that samples are placed on the shelves in the Stoppering Tray Dryer in a uniform pattern if vials will be stoppered. All vials on any single shelf must be the same size. At least 1 vial should be located at each of the 4 corners. Failure to adhere to this procedure could cause damage to the stoppering mechanism.

- For full operating instructions see the Stoppering Tray Dryer and Console Freeze Dryer User's Manuals.