

TOP VIEW

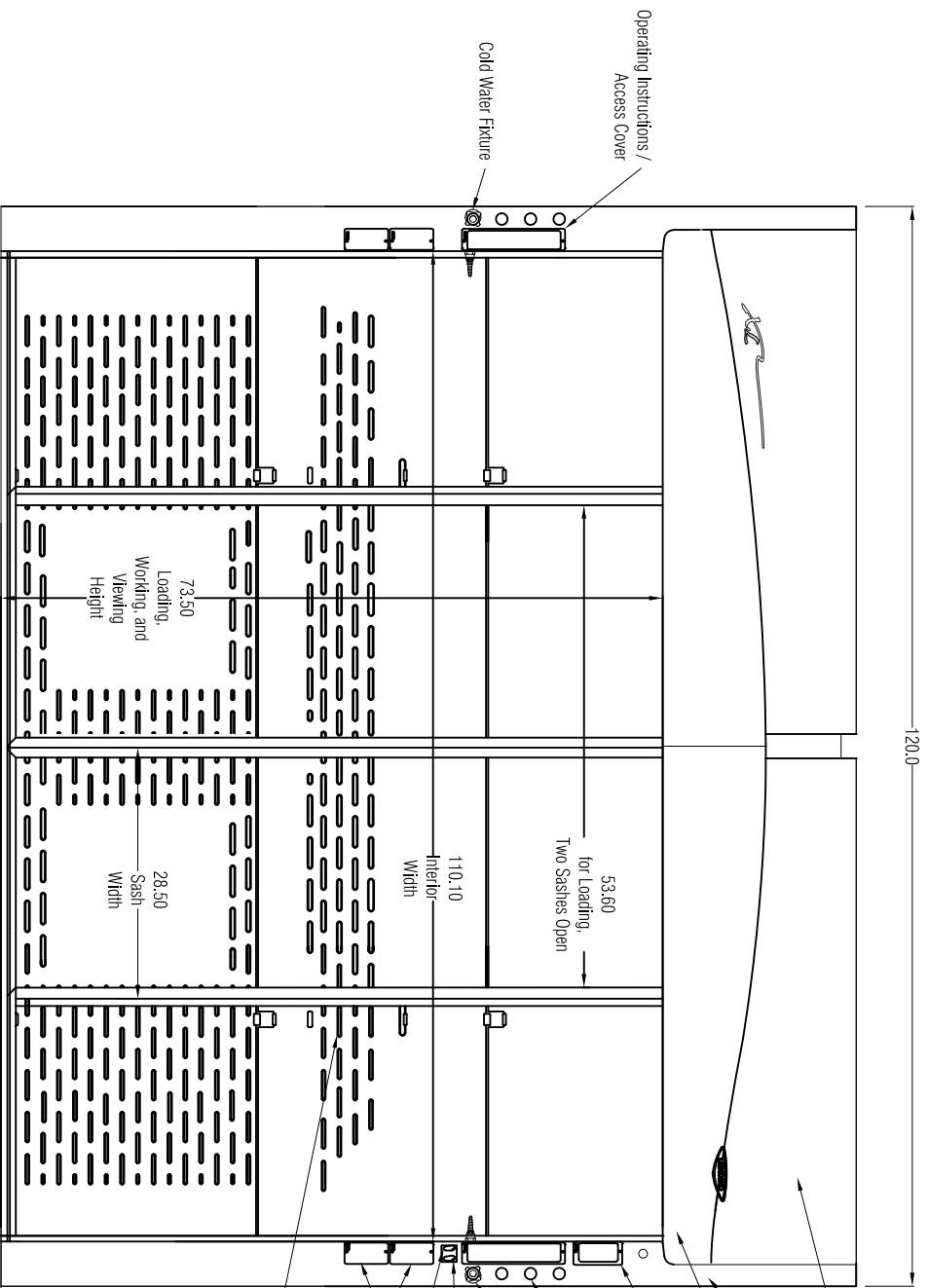

FRONT VIEW

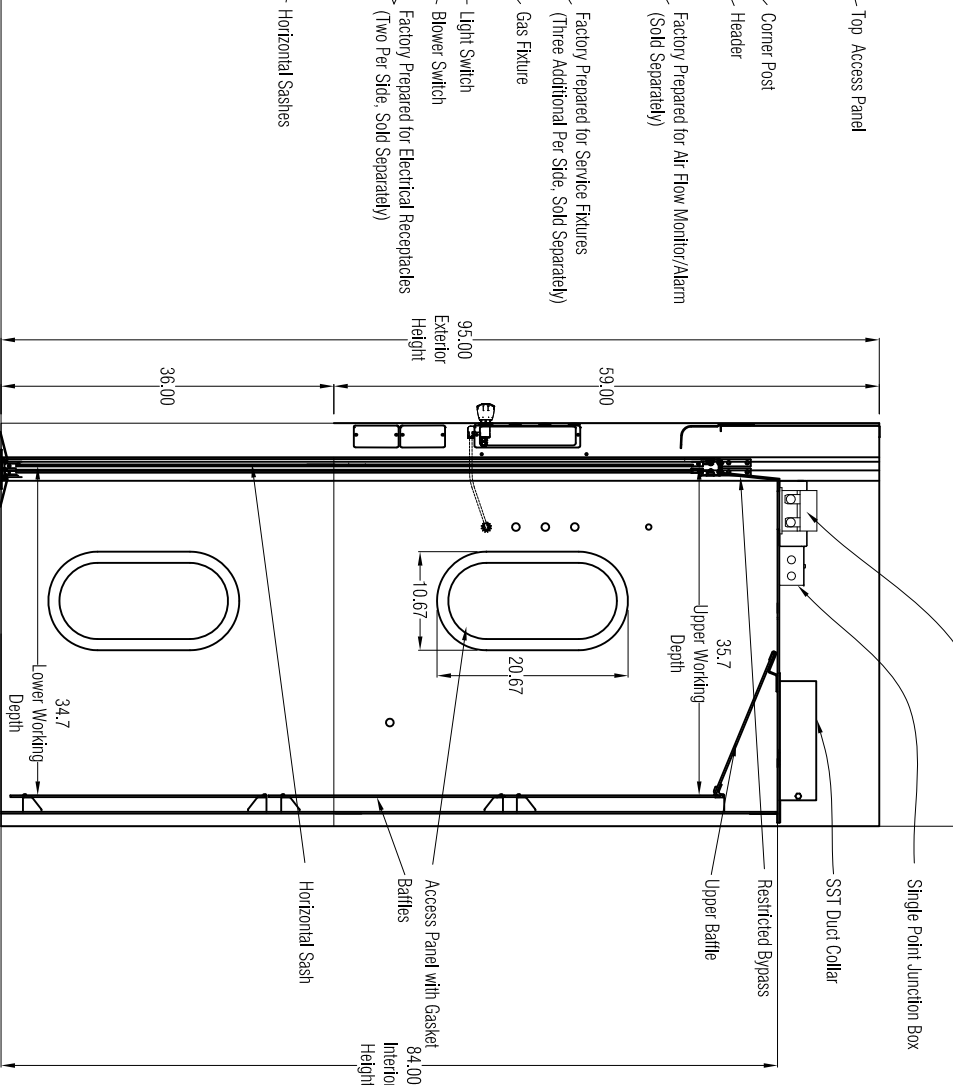

SIDE VIEW

GENERAL DESCRIPTION

10' Protector XL Floor Mount Hood, 43.7" Exterior Model: 112026021

- * Exterior Superstructure
- * Double Wall Construction * 18 Gauge Cold Rolled Steel
- * Interior Superstructure
- * Galvanized Steel (standard)
- * Left / Right Facia:
- * Powder Coated Steel * Color: Glacier-White
- * Liner Material:
- * Molded Composite Sheet
- * Side Panels:
- * Both Sides * Removable * Color: Glacier-White
- * Baffles
- * Molded Composite Sheet
- * Interior Access Panels
- * Right and Left Sides
- * Gasket Provided
- * Corner Post with Access Covers
- * Right and Left Sides
- * 18 Gauge Cold Rolled Steel Sash
- * Horizontal Sash
- * Tempered Safety Glass
- * Electrical Fixtures:
- * LED Light and Tubes w/ Switch Alarm / Monitor (Sold Separately)
- * Factory Prepared for Air Flow Monitor/Alarm

- * Fume Hood Wired at Factory
- * Electrical Connection made inside 4x7 Junction Box
- * 208-230, 50/60 Hz
- * VAV Preparations
- * Restricted Bypass for VAV
- * Service Fixtures:
- * Labconco * Color-Coded Hooded Handle * Front Loading
- * Ports included to convert standard fixtures to Vacuum or Air

| Symbol | Service | Color |
|--------|----------------|--------|
| CW | Cold Water | Green |
| G | Gas | Blue |
| CA | Compressed Air | Orange |
| V | Vacuum | Yellow |

- Plumbing**
- * Connections Made with Swagelok Compression Fittings
- * Final connection by others
- * Pre-Piped to Valve Outlet 1/4" Copper Tubing
- * Standard Metering is 1/4" Copper Tubing
- * All other piping is 1/4" Brass Tubing
- * Standard Gas Piping is 1/4" Brass Tubing
- * Required Accessories (Sold Separately)
- * Remote Blower

| Airflow Volumetric Rate (CFM) @ Static Pressure (inches of water) | |
|---|------------------|
| Face Velocity (fpm) | 1 Sash Full Open |
| 100 | 1450 @ 0.22" |
| 80 | 1160 @ 0.14" |

Assembly and Crating
 * Floor-Mounted Fume Hoods are shipped partially unassembled and require field assembly (not provided by Labconco). Assembly includes placement of lower and upper portions, installation of corner posts, baffles, header, and sashes, and connection of piping and electrical (if included). Detailed instructions are available at: <http://www.labconco.com/resources/manuals> or upon request.
 * Palletized (2 pallets for 10 ft. floor-mounted hood)

SCALE: Scaled to fit



LABCONCO CORPORATION • KANSAS CITY MO USA 64132
 800-821-5525 / 816-333-8811 • labconco.com

FUME HOODS for:

| Rev | Date |
|-----|------|
| | |
| | |
| | |
| | |

Date: July 2023
 Drawing #: 112026021
 Drawn By: C. Alumbaugh
 Checked By:
 Approved By:
 Sheet No.: